

A96087



Installation Instructions:

EXTERNAL HALYARD VERTICAL WALL MOUNTED FLAGPOLE SYSTEM

The external halyard vertical wall mounted system is simple in function and easily rigged, this flagpole will provide years of service with only occasional maintenance.



EXTERNAL HALYARD VERTICAL WALL MOUNTED FLAGPOLE SYSTEM

**FOR QUICK AND PROFESSIONAL INSTALLATION
READ ALL INSTRUCTIONS BEFORE PROCEEDING.**

Lay all flagpole components out. If missing a part from the attached parts diagram, please call (800) 368-7171 for the replacement parts.

STEP 1 - Remove all wrapping materials and place unwrapped pole on cribbing or other wood support on ground (preferably in a covered dry area). If Pole is Multi Section, carefully lay sections out in proper order, grouping poles with like match marks. Sections **MUST BE STRAIGHT & LEVEL** while sliding together. Line up match mark numbers, imprinted at each section, for proper fit. Lightly sand away any burrs that may be present on the male section or in the upper section of the joint. A small amount of lubrication (silicone or dish washing liquid – by others) may be applied to the male portion of the joint for easier fitting. Start with the bottom sections and work toward the top. Begin sliding the two sections, rolling the pole by 180° with every 2 to 3 inches to facilitate an easier fit. (If EXTREME difficulty is found in fitting the first 6 inches together, pull back apart and cool the male section with ice for several minutes). A sledgehammer and block of wood (to protect the pole from direct impact) may be necessary on larger poles to complete the assembly of joints. American Flagpole suggests the use of an epoxy adhesive for aluminum with poles of 60' length.

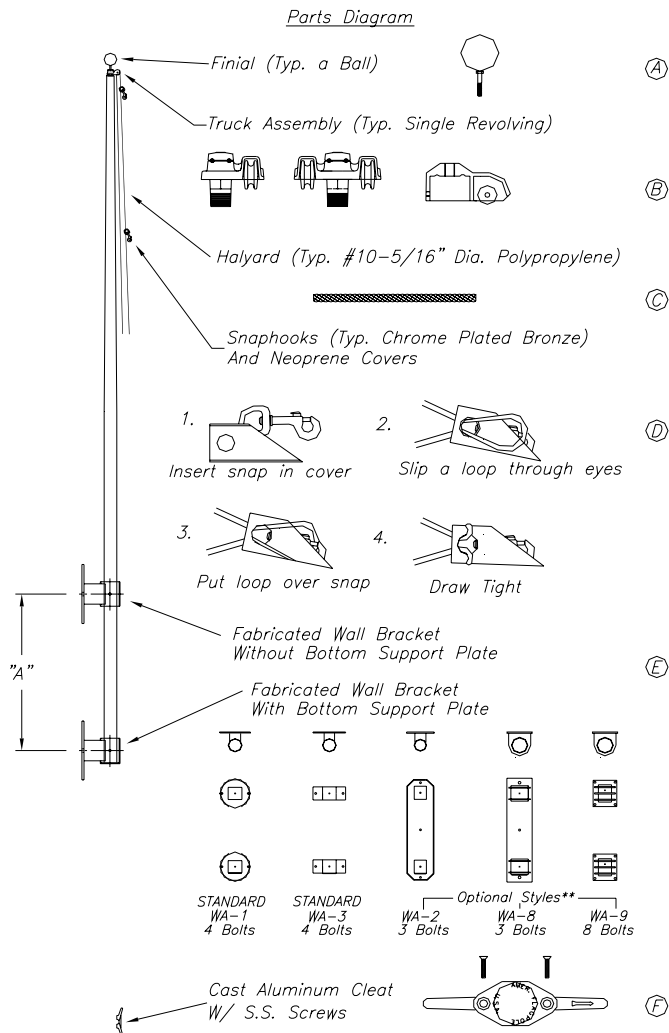

STEP 2 - Identify parts and place them along the pole.

STEP 3 - Starting with the finial ball (**part A**), screw the ball's spindle into truck (**part B**). **Do not grip ball to tighten, grip spindle/rod with vise grips and tighten.** Tighten all nuts and set screws. **(Epoxy or loc-tite type product is recommended on all connections, this material not furnished by American Flagpole).**

STEP 4 - Attach the truck (**part B**) with ball by screwing into the threaded top of the flagpole (Do not epoxy spindle of truck). If truck (**part B**) is a stationary truck, be sure to secure all set screws.

STEP 5 - Feed the polypropylene rope (**part C**), around the pulley of the truck (**part B**) and down the side of the flagpole. Tie both ends together forming a complete loop. Space the snap hooks and neoprene covers (**part D**) at equal distance on either side of the knot to accommodate flag size (refer to diagram on parts page for snap hook attachment).

STEP 6 – Install wall brackets (**part E**) onto designated surface. **(Recommended minimum wall bracket spacing “A” is 10% of overall pole height. For example if overall shaft height = 30ft., then “A” dimension = 3ft.)**

STEP 7 - Fasten cleat (s) (**part F**) into position using the screws provided in the hardware packet. **IMPORTANT NOTE:** The cleat(s) are typically installed onto wall surface. Use cleat as template for installation. A pilot hole or drilling oil may be used to facilitate installation. **For cleat box installation,** use drill and tap kit to prepare holes onto designated surface. Align box and cleat over holes, and fasten to wall using provided bolts.

STEP 8 - Stand flagpole into previously installed wall mounted brackets. (May require crane or backhoe for larger flagpoles. Always choke multiple section poles below lowest joint as a safety precaution). **Caution: When installing, the pole should be assembled as close as possible to the final support point. Professionals experienced in such installations should perform rigging and lifting. During lift keep clear of area and reach of pole path. Do not pass pole overhead. When installing multi-piece flagpoles, arrange the rigging for the lift in such a way that weight of the pole sections is supported from the bottom of the pole so that the flagpole joints are pushed together not pulled apart during the lift. Keep clear of power lines.**

STEP 9 - After inserting flagpole into wall brackets, plumb flagpole, then tighten set screws that are provided with wall brackets .